

Black Tuffy Carts



WT42CE



WT34CC



WT16E



WT26E



WT26CE



WT34E

Round vs. Square Legs

Which is a better choice? A 1½" square leg has 6" of gripping surface diameter. A 1½" round leg has only 4¾" of gripping surface diameter. A round leg will also twist and loosen over time, while a square leg will stay fixed in position.

Dimensions

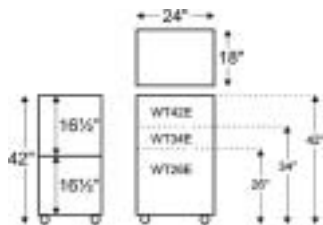

If there were a **Hall of Fame** for audio/visual carts, the black Tuffy cart would be the first inductee. High-quality materials, easy assembly and **thousands of uses** have made these models the standard to which other carts are measured. Until the Cart Hall-of-Fame opens, that may be the highest form of praise.

Technical Information at a Glance:

- ✓ Shelves and legs are made from recyclable material.
- ✓ Four 4" full swivel ball bearing casters, two with locks.
- ✓ Shelves are 18"D x 24"W x 1½"H with ¼" retaining lip.
- ✓ Legs are 1½" square tube.
- ✓ Cabinets are made from 20 gauge steel.
- ✓ Cabinet door clearance is 13½"H x 17"W.

All Tuffy carts are constructed from injection-molded thermoplastic that will not chip, warp, crack, rust or peel. All Tuffy shelves have a ¼" safety retaining lip. Included with every Tuffy cart is a 3-outlet UL/CSA electrical assembly and three cable management clips. Our UL listed models (UL13 for 13" TVs, and UL20 for 20" TVs) also include our 8" Big Wheel Kit and our tip-resistant ballast system. Cabinets are steel with a choice of black or putty powder coat finish.



Available Options!

M.S.R.P.

- Big Wheel Substitute Kit (BW-C/A) . . \$77.00
- 42"H Cart Skirting (SK42) \$129.00
- Safety Strap (ESS) \$16.00
- Heavy-Duty Strap (EHS) \$40.00
- Ratchet Strap (ERS) \$40.00

Model	Colors	Shelves	Height	Width	Depth	Weight	Electrical	Cabinet	UL Listed	M.S.R.P.
WT16E	BLACK	2	16"	24"	18"	21lbs.	✓	-	-	\$180.00
WT26E	BLACK	2	26"	24"	18"	22lbs.	✓	-	-	\$192.00
WT34E	BLACK	3	34"	24"	18"	28lbs.	✓	-	-	\$204.00
WT42E	BLACK	3	42"	24"	18"	29lbs.	✓	-	-	\$212.00
WT26CE	BLACK	2	26"	24"	18"	40lbs.	✓	✓	-	\$375.00
WT34CE	BLACK	3	34"	24"	18"	46lbs.	✓	✓	-	\$395.00
WT42CE	BLACK	3	42"	24"	18"	47lbs.	✓	✓	-	\$403.00
WT1642E	BLACK	3	16"- 42"	24"	18"	30lbs.	✓	-	-	\$227.00
WT2642CE	BLACK	3	26"- 42"	24"	18"	48lbs.	✓	✓	-	\$414.00
WT42BEUL13	BLACK	3	42"	24"	18"	40lbs.	✓	-	✓	\$332.00
WT42BEUL20	BLACK	3	42"	24"	18"	55lbs.	✓	-	✓	\$352.00
WT42CEUL13	BLACK	3	42"	24"	18"	59lbs.	✓	✓	✓	\$536.00
WT42CEUL20	BLACK	3	42"	24"	18"	75lbs.	✓	✓	✓	\$557.00

